

KEILHAUER

Syz Table with Power  
**Assembly Guide**



## Hardware Included

(1) Pneumatic Driver Gun

(1) Hex Bit

(1) Hex Allen Key

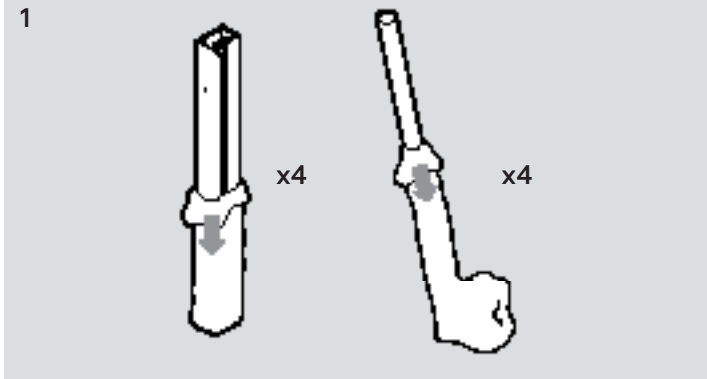

Peel back protective polyfoam on table legs and extrusions.

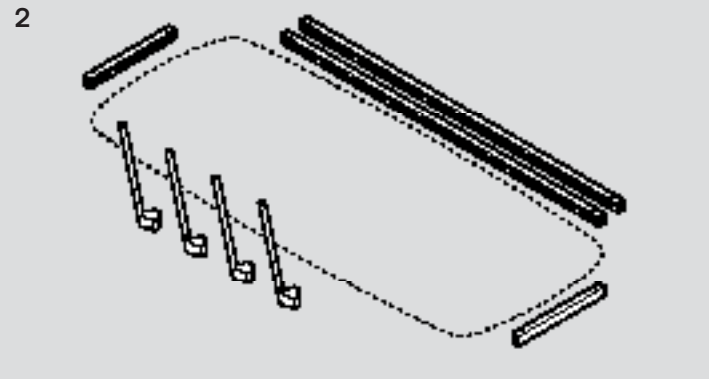

Prepare a well-padded surface to assemble the base upside-down.

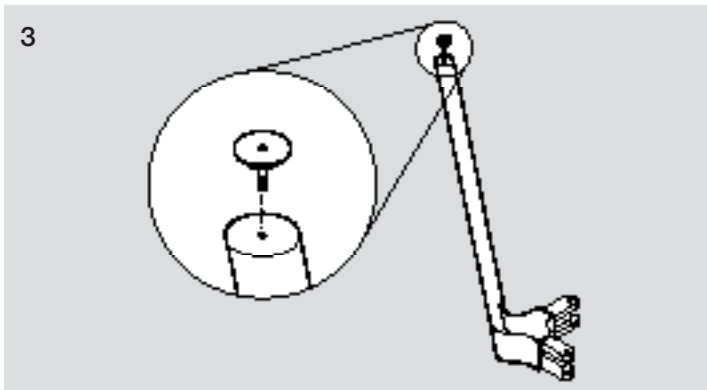

Screw the table glides into each table leg.

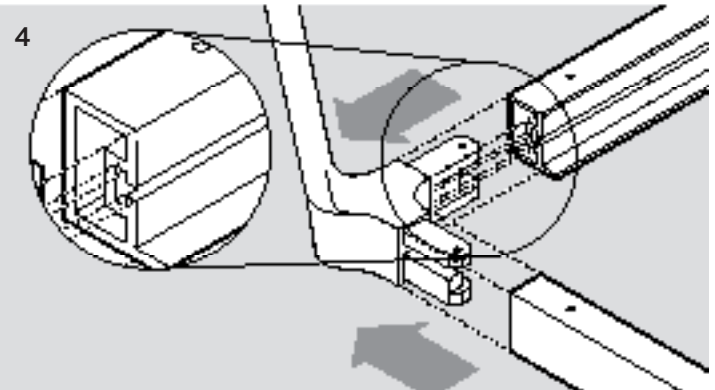

Slide the base extrusions over the table leg inserts. Face the channelled side of the extrusion inwards.

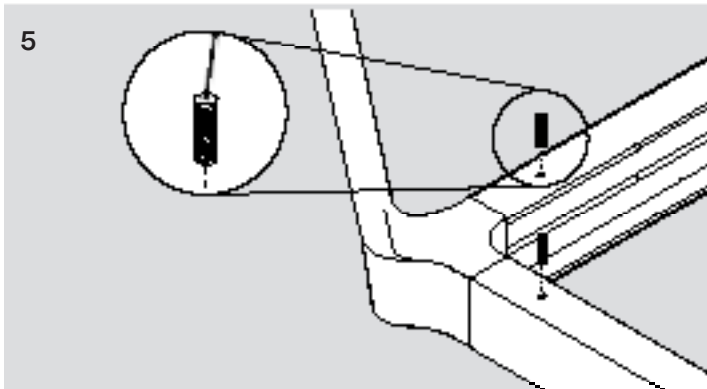

Line up the extrusion and leg insert set screw holes and insert the (x2) 5/16-18 x 1" set screw, first tightening the screw by hand to ensure the screw is threading correctly, then using a flat head screwdriver to complete.

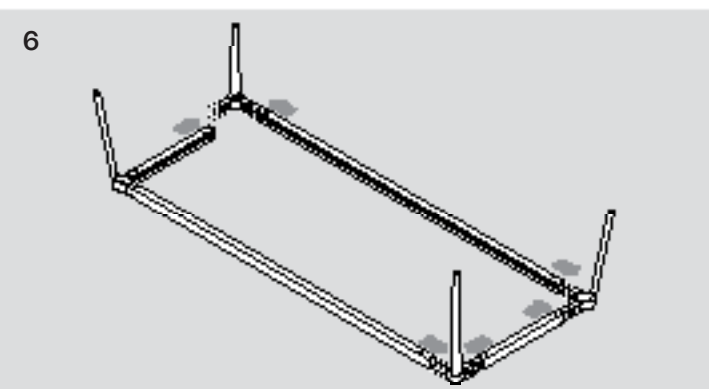

Repeat step 5 for the remaining 3 corners.

## Hardware Included

(8) 5/16-18 x 1" Set Screws

1/4-20 x 3/4" Hex Socket Screws  
(8) 60° (2) 72°/78°x42°/64°/  
90°x44°/90°x50° (16) 96°/102°/  
108°/114°/120°x44°/120°x50°

(8) 8-15 x 3/8" Pan Head Screws

(4) 4-15 x 1/4" Socket Pan Head Screws

(4) 5/16-18 x 1 1/2" Quad Pan Screws

(4) 8-15 x 5/8" Quad Pan Screws

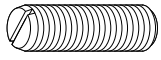

(4) Nylon Spacers

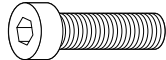

(2) Bottom Tabs

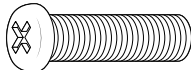

(2) Bottom Weights

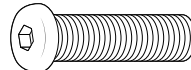

(4) Slot Nuts

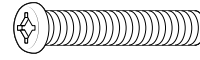

(4) Glides

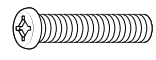
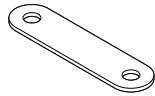
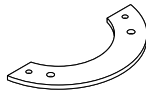

Table Top Mount Clips  
(8) 60° (2) 72°/78°x42°/64°/  
90°x44°/90°x50° (16) 96°/102°/  
108°/114°/120°x44°/120°x50°



(2) Zip Bolt Connectors  
(for models with two-piece table tops)



(2) Bottom Weights  
(for models with two-piece table tops)

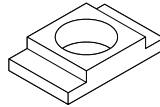

(4) Slot Nuts  
(1 or 2 depending on model ordered)

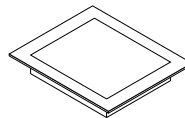
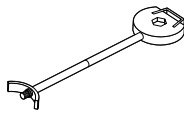
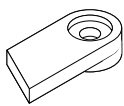

7

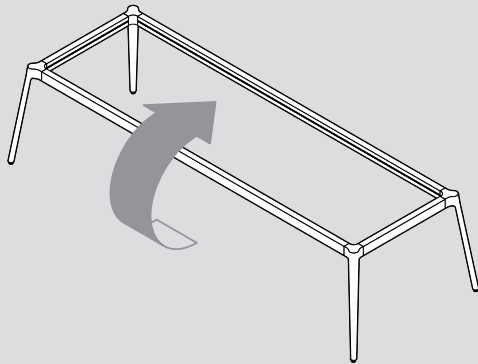

Flip the base over.

8

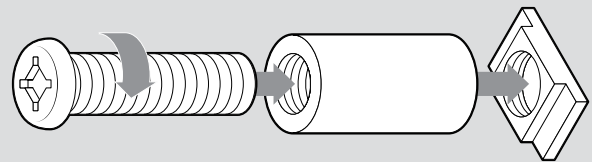

Fit the 4 nylon spacers over the 5/16-18 x 1 1/2" quad pan screws and leave loose.

9

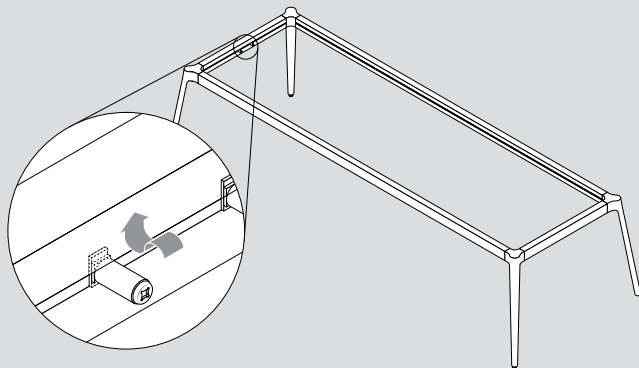

Slide 1 of each of this assembled hardware into the channels of two opposite extrusions (the depth-side extrusions if assembling a rectangular table).

10

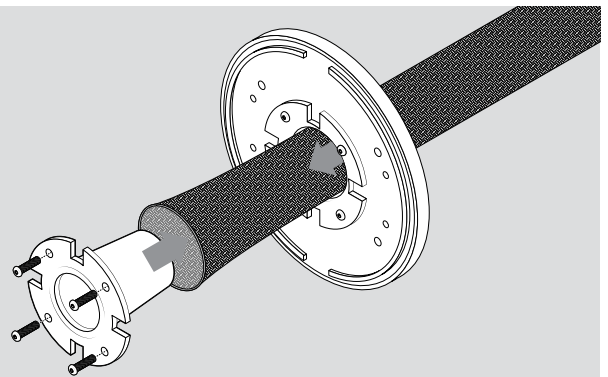

To assemble the cable management system, feed the mesh tube through the large black plastic disc, and then secure the mesh tube to the disc by inserting 1 of the collar tube fasteners inside the bottom of the mesh and screwing the base of the collar to the underside of the disc with 4 8-15 x 3/8" pan head screws.

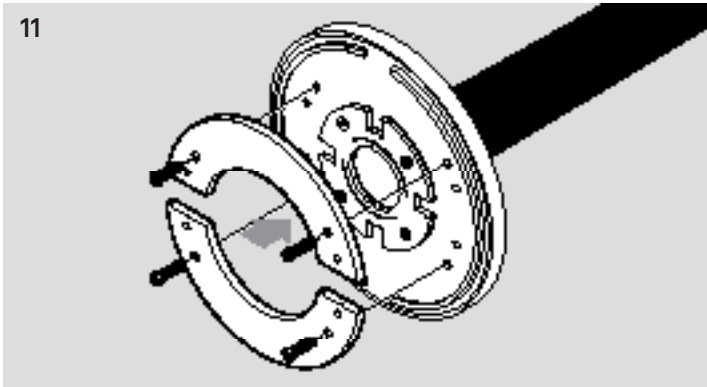

11 Attach the 2 bottom weights to the underside of the black disc with the 4 8-15 x 5/8" quad pan screws.

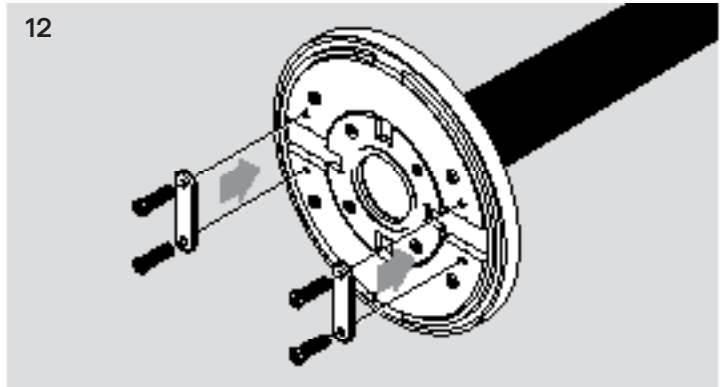

12 Attach the 2 white bottom tabs with the 4 4-15 x 1/4" socket pan screws.

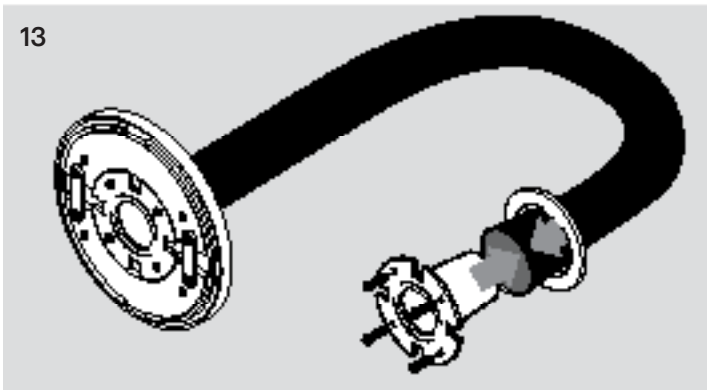

13 Feed the other side of the mesh tube through the smaller black plastic disc, and use the second collar tube fastener to secure the disc and mesh in the same way as in step 10.

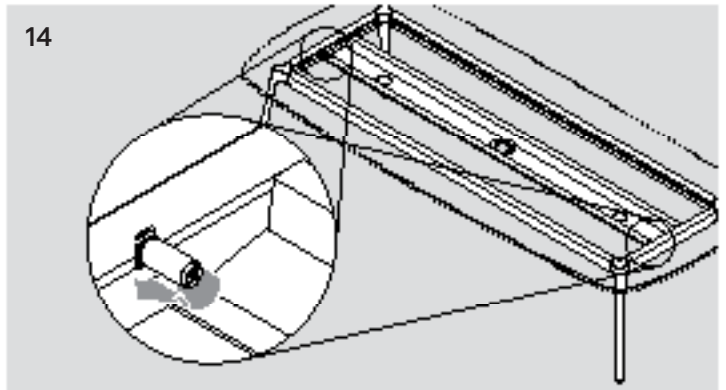

14 To affix the cable management system to the table base: loop one of the conduit ends around the nylon spacer coming out from the extrusions on either side. Next, secure in place by inserting the remaining 2 nylon spacers and sliding them into place so the other side of the conduit can be looped around them, then tighten the spacers in place.

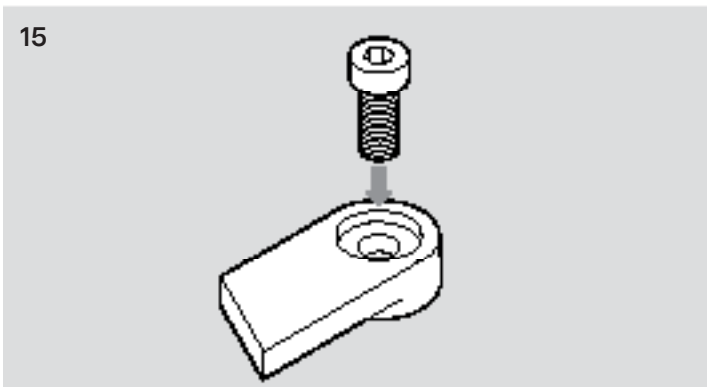

15 Assemble table top mount clips and corresponding 1/4-20 x 3/4" set screws.

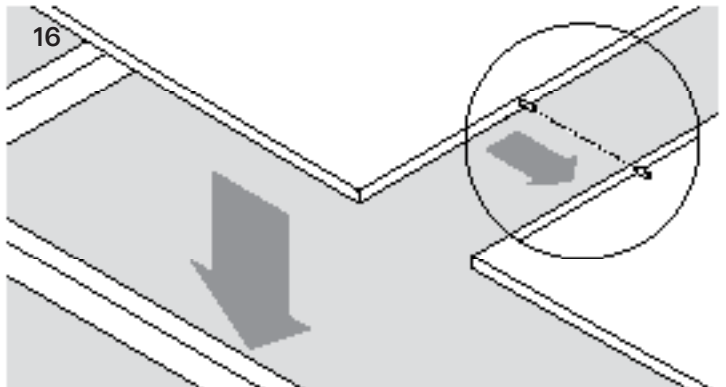

16 **For two-piece table tops:** Place the table top on the base. If the top is in two pieces (for models that are 72" round or square; 84" round), fit the dowels into the holes on one half of the top and push the halves together.

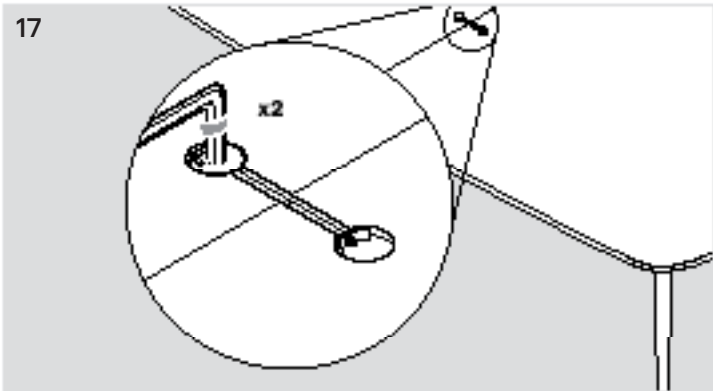

**For two-piece table tops:** Place the two zip bolt connectors in the corresponding depressions in the underside of the table top, and use the allen key to tighten and hold the halves together

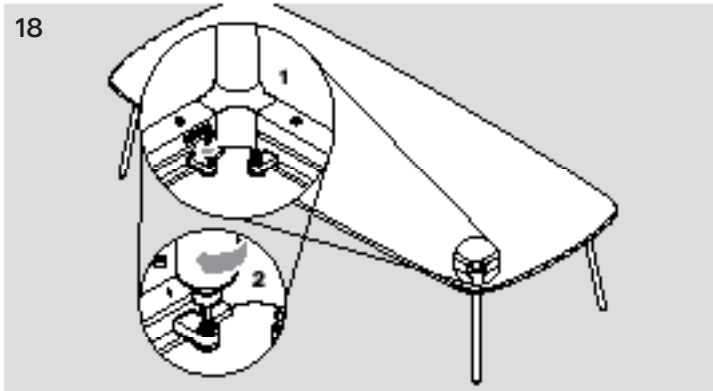

Ensure the threaded inserts on the underside of the table are aligned with the base extrusions and screw in the table top mount clips loosely, rotating them so that they clip the top to the lip of the extrusions, then once in place tighten all clips with the driver gun to secure the top to the base.

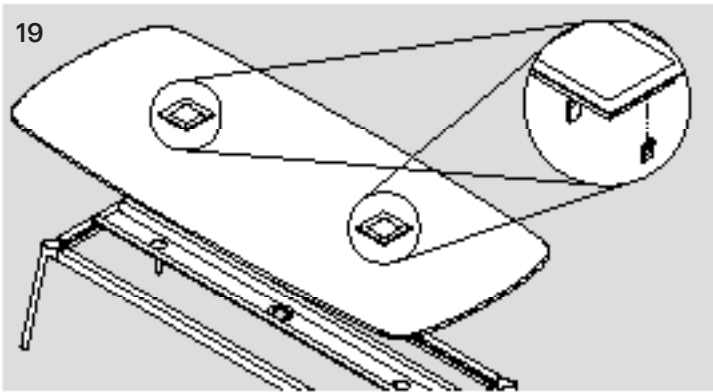

Insert the power box(s) into the space(s) on the table top, feeding the cord through first. Clips are included to secure the power unit and cord into place. Push the clips into the power unit and use a clip and adhesive to secure the cord. Firmly press the power unit into place.

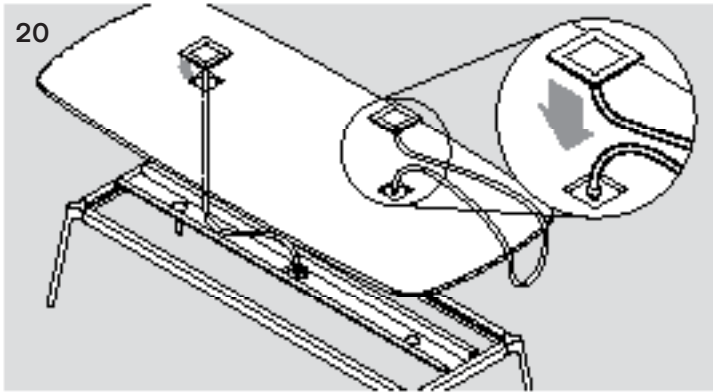

Line the cable management system under the top and feed the power cords along the conduit as you lift the system up to align with the extrusions.

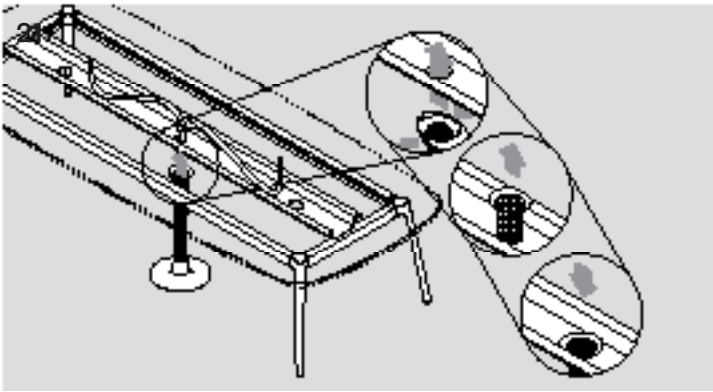

To affix the mesh tubing to the cord management conduit squeeze the sides of the tube at the small disc end to move the clips forward, and insert through the appropriate gap in the conduit. Release pressure and the clips will move back, securing the tube system to the cord management conduit. Feed power cord through the tubing while affixing to the conduit.

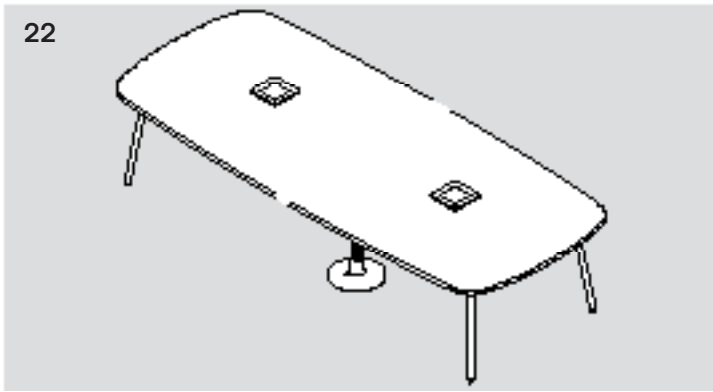

**Move the table into place and adjust the glides to provide a level surface.**

**Syz Tables with Power** Designed by EOOS

keilhauer.com  
1450 Birchmount Road  
Toronto, Ontario, Canada  
M1P 2E3  
T 416 759 5665  
F 416 759 5723  
1 800 724 5665